

# Types of Syringes & Needles





# Syringe

- A syringe is a simple pump consisting of a plunger that fits tightly in a tube to assist pushing liquids or solids into an object either through a needle, tubing, or a nozzle.
- The most common use of a syringe is to administer injections into the body

# Anatomy of a Syringe

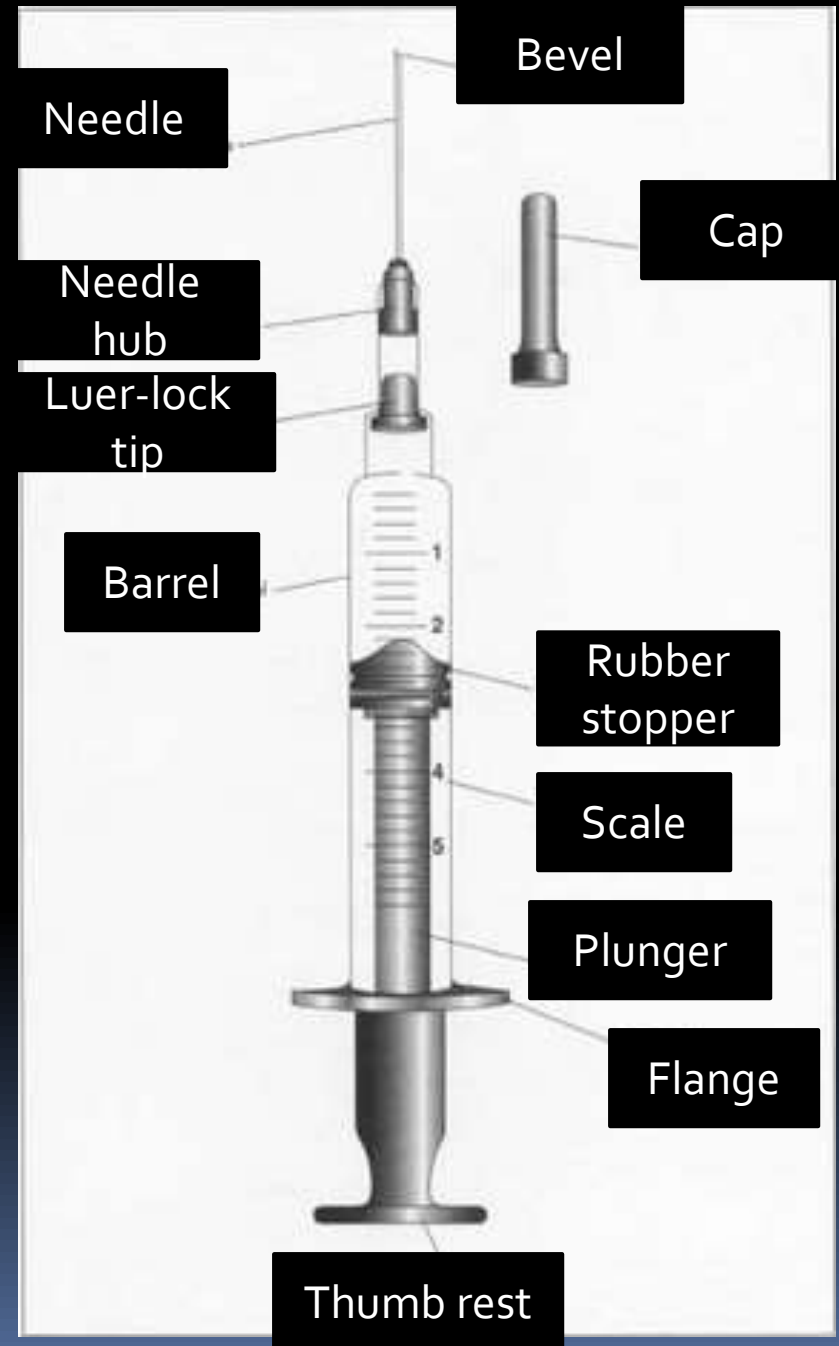
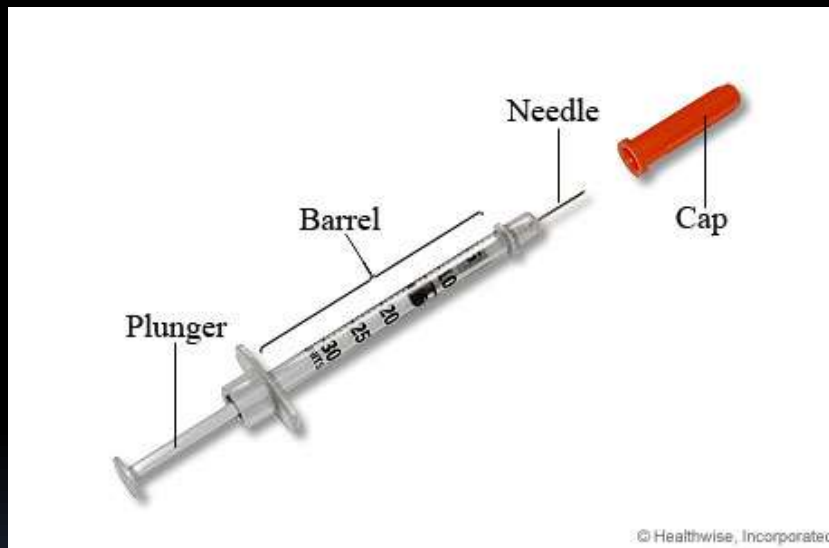

# Syringes are available in various sizes

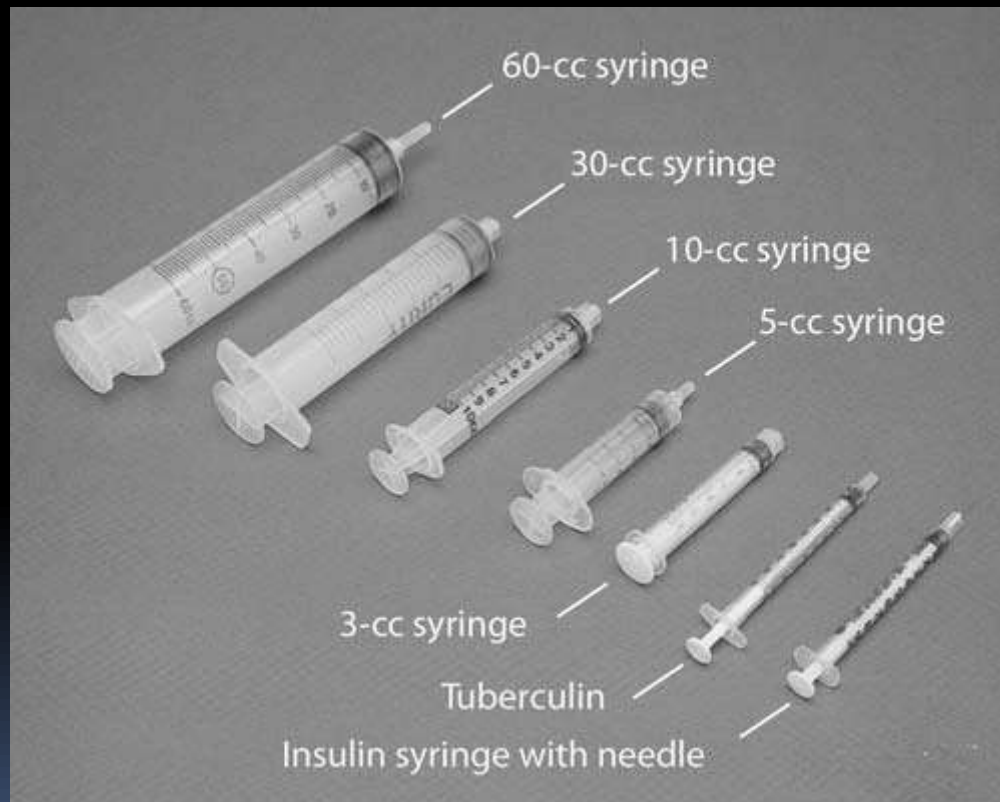

# Syringe Size

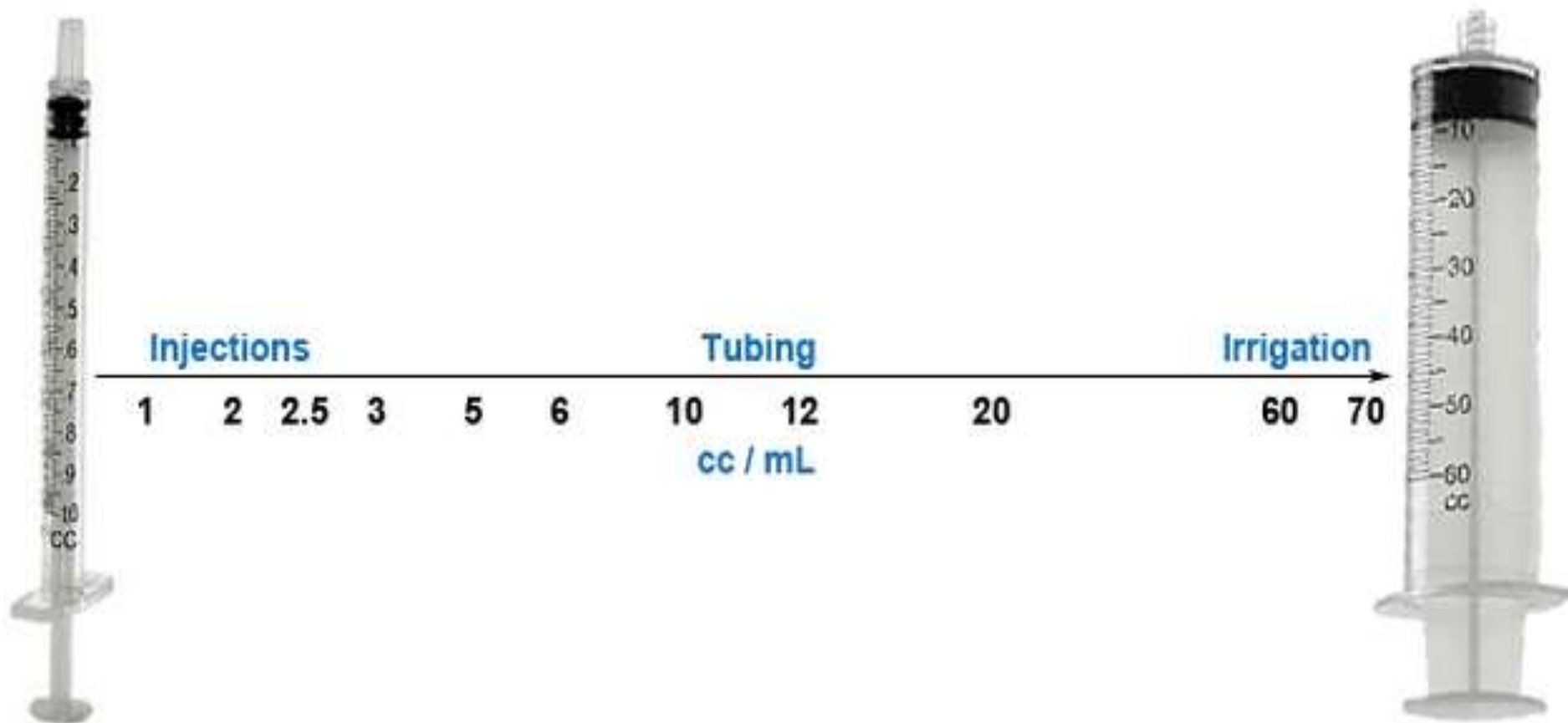

- Smaller volumes mostly used for subcutaneous & intramuscular injections.
- The Larger the syringe size, the lower the pressure flow.
- 10 to 12 mL commonly used for central lines, catheters, medical tubing.
- 20 to 70 mL commonly used for irrigation.

# Anatomy of a Needle

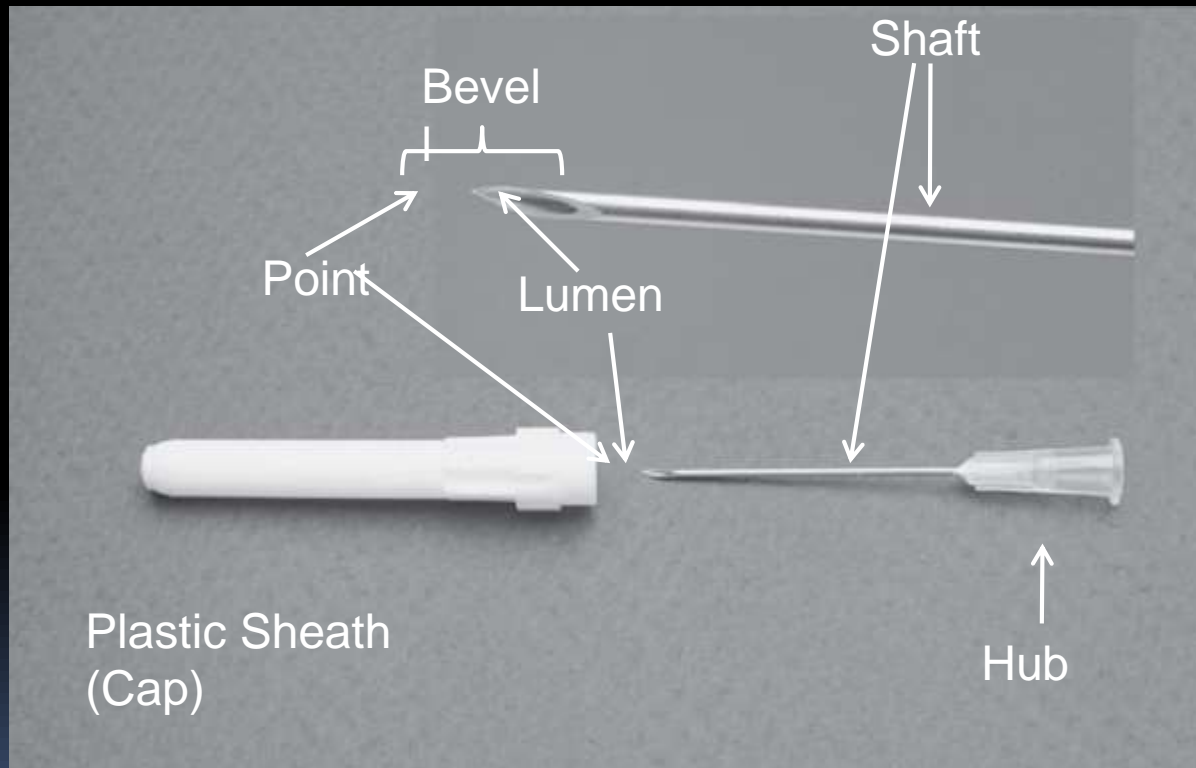

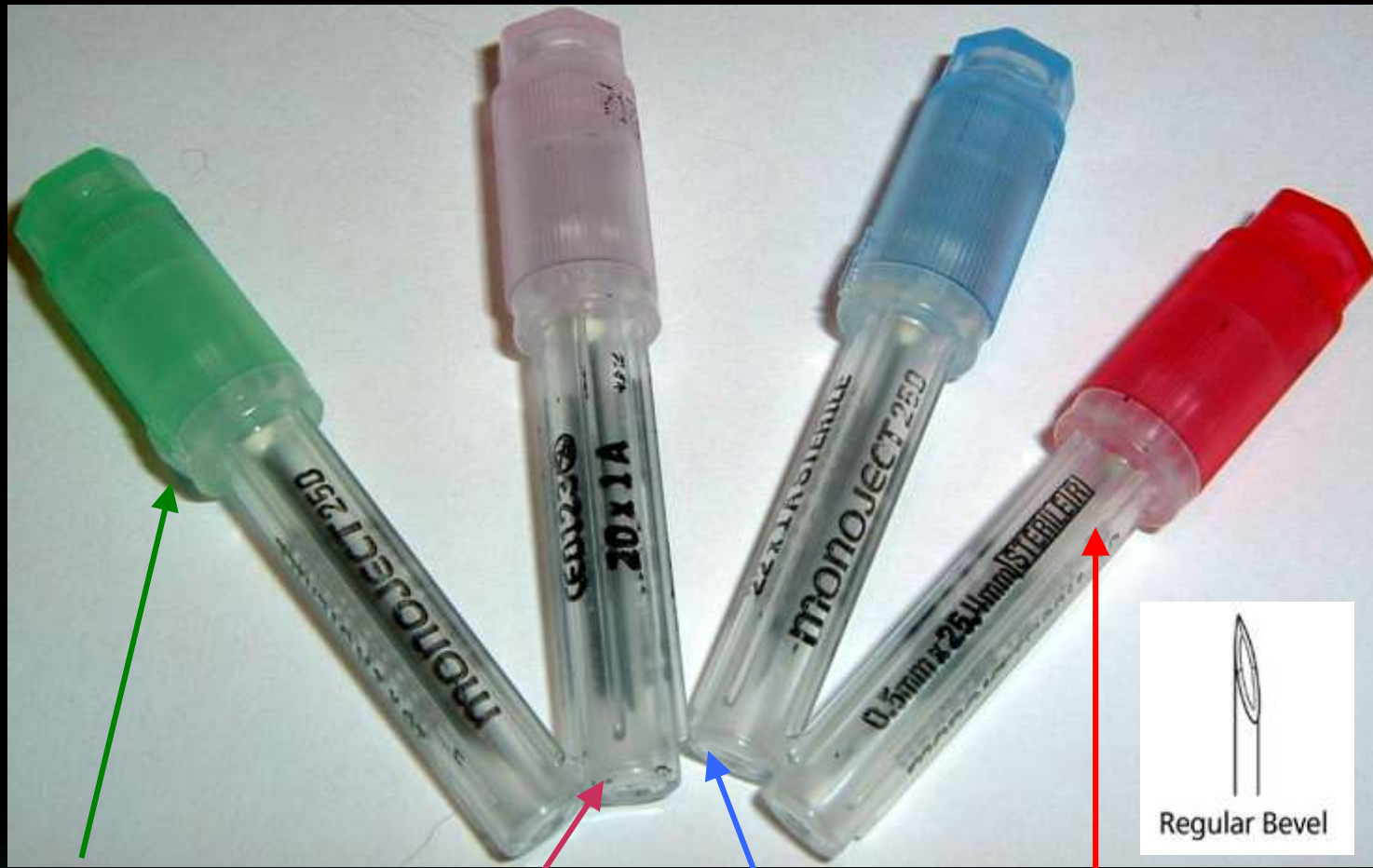

18 gauge x 1 in

20 gauge x 1 in

22 gauge x 1 in

25 gauge x 1 in

Various needles commonly utilized with injections Gauges in relation to their colors. [Buy Syringes Online](#) from multiple categories and various products.

# Syringe Type Selection





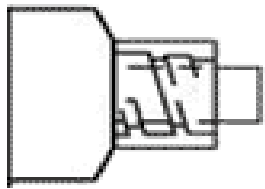

**BD Luer-Lok™  
Tip**

Generally used for injections requiring a secure connection of the syringe to another device. The tip is threaded for a 'locking' fit, and is compatible with a variety of needles, catheters, and other devices.

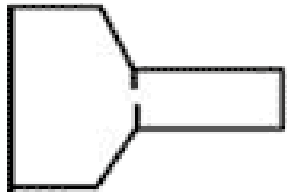

**Luer Slip Tip**

A friction-fit connection that requires the clinician to insert the tip of the syringe into the needle hub or other attaching device in a push-and-twist manner. This will ensure a connection that is less likely to detach. Simply sliding the attaching device onto the syringe tip will not ensure a secure fitting.

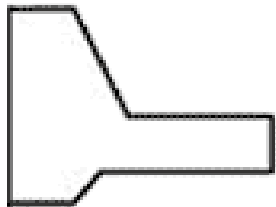

**Eccentric Luer  
Slip Tip**

Allows for work requiring closer proximity to the skin. Generally used for venipunctures and aspiration of fluids. (Also see luer slip instructions above).

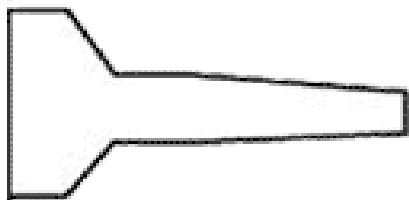

**Catheter Tip**

Used for flushing (cleaning) catheters, gastrostomy tubes and other devices. Insert catheter tip securely into catheter or gastrostomy tube. If leakage occurs, refer to your facility's guidelines.

# INSULIN SYRINGE

- Significantly small in size and are capable of holding 0.3 to 1 ml of medication.
- Use for Subcutaneous Injections
- Finer gauge needles, for less pain.



# Comparison of Common Parenteral Routes of Drug Administration

Intramuscular  
90°

Intravenous  
25°

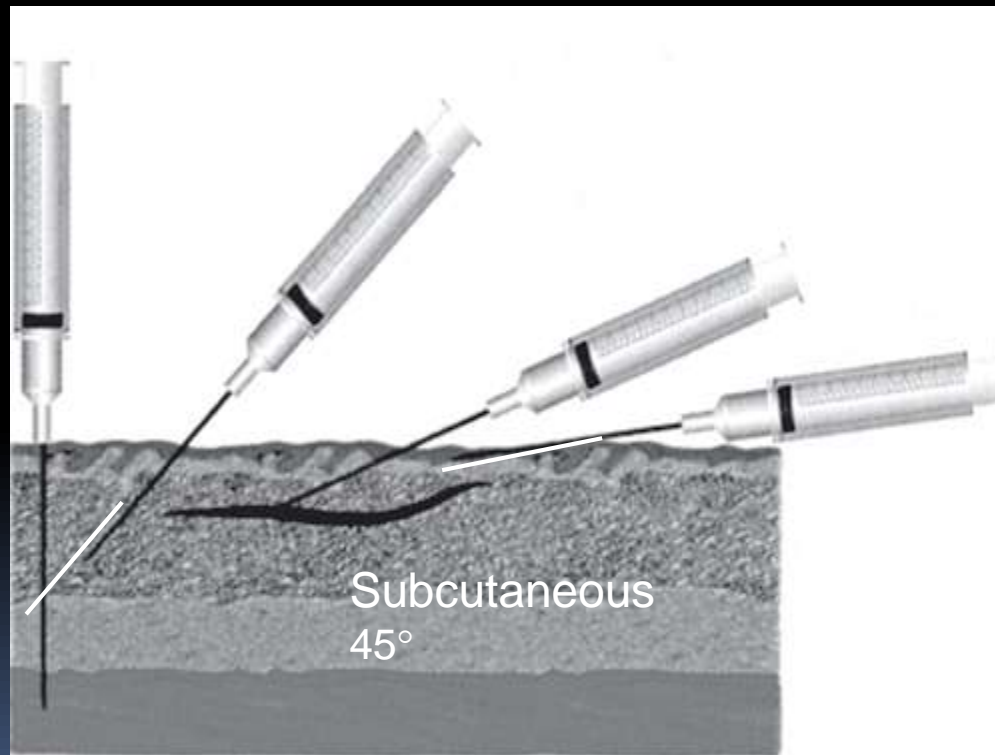

Intradermal  
10°–15°

Epidermis

Dermis

Subcutaneous tissue

Muscle

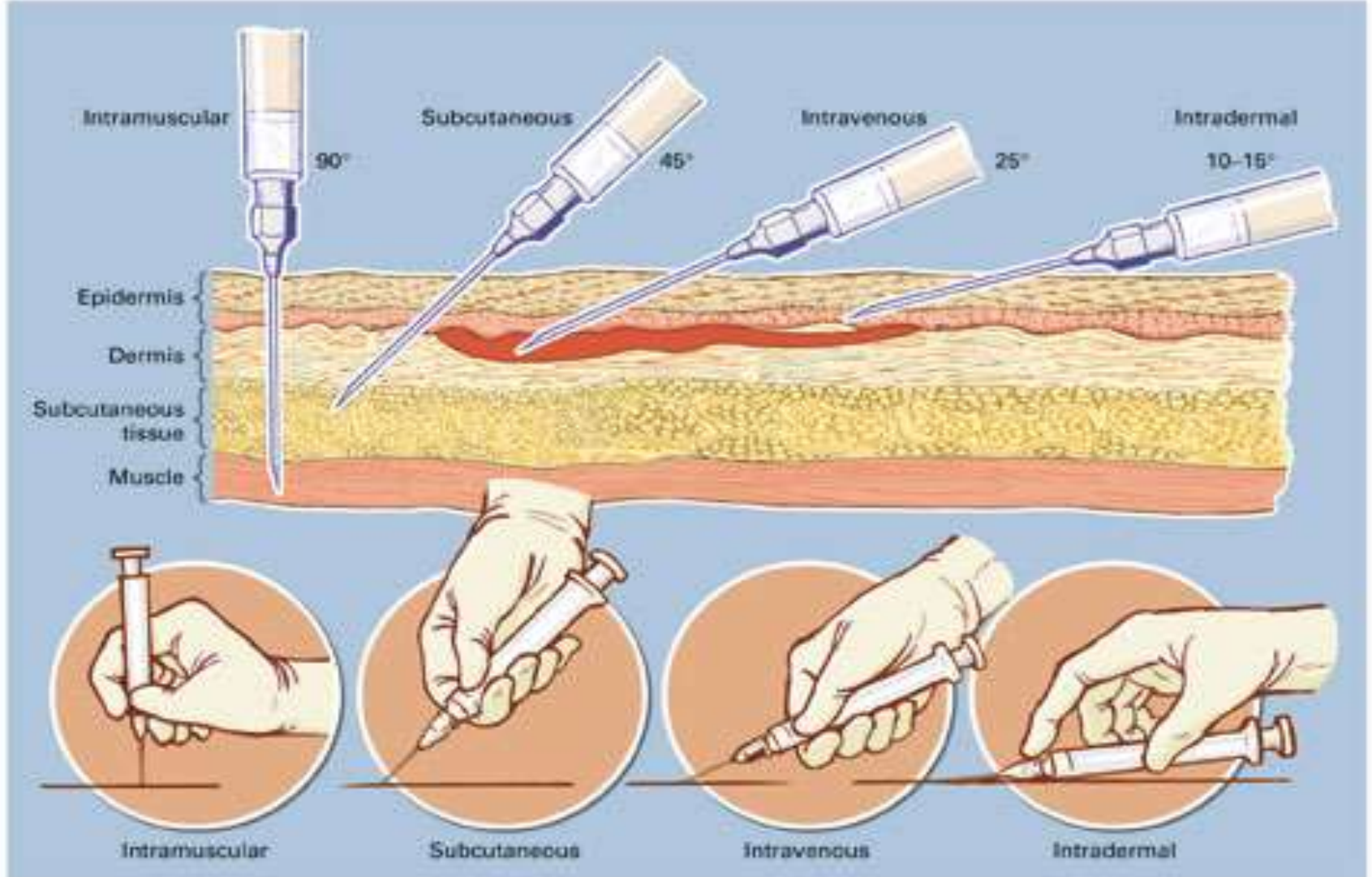

# I.V. (Intravenous) catheters

- These catheters allow to administer medication directly into the venous system for rapid distribution to the whole body.
- Medication given this way acts faster and is more controllable, a significant advantage for an ill pet or in an emergency



# I.V. catheters Placement

- Cephalic Vein: This is by far the most common vein to use. It runs along the top of the foreleg of dogs and cats.
- Jugular vein: This vein is in the neck. A catheter placed in this vein allows longer term use and the ability to give larger volumes of medication with different viscosity's.
- Saphenous Vein: This vein is on one of the back legs. It is mostly used when the cephalic vein is unusable.

# Contact Us

## Gway Healthcare Products Inc.

**112 East Fremont Ave,  
Sunnyvale, CA - USA**

**Phone No: 408-735-7444  
info@gwaymedical.com**

**Visit us for more Syringes and Needles**

**<https://www.gwaymedical.com/syringes-needles-infusion.html>**

 Follow us on Google+

 Follow us on Facebook

 Watch us on Youtube

 Follow us on Twitter